

COPY

THE INVERCLYDE COUNCIL
(OFF-STREET PARKING PLACES)
(VARIATION NO. 7) ORDER 2016
TRAFFIC REGULATION ORDER

**THE INVERCLYDE COUNCIL
(OFF-STREET PARKING PLACES) (VARIATION NO. 7) ORDER 2016**

We, The Inverclyde Council in exercise of the powers conferred on us by Sections 1(1), 2(1) to (3), 4(2), 32(1), 35(1), 45, 46, 49, 53, 101 and 102 of the Road Traffic Regulation Act 1984 (as amended) ("the Act") and of Part IV of Schedule 9 to the Act and of all other enabling powers and after consulting the Chief Constable of the Police Service of Scotland (Seirbheis Phoilis na h-Alba) in accordance with Part III of Schedule 9 to the Act hereby make the following Order:

1.0 Commencement and citation

1.1 This Order shall come into operation on the Fourteenth day of November, Two Thousand and Sixteen and may be cited as "The Inverclyde Council (Off-Street Parking Places) (Variation No. 7) Order 2016".

2.0 Interpretation

2.1 Except where otherwise stated, any reference in this Order to a numbered Article or Schedule is a reference to the Article or Schedule bearing that number in this Order.

2.2 Any reference in this Order to any enactment shall be construed as a reference to that enactment as amended, modified, re-enacted, replaced or supplemented by any subsequent enactment.

2.3 The prohibitions and restrictions imposed by this Order shall be in addition to and not in derogation from any restriction or requirement imposed by any regulation made or having effect as if made under the Act or by or under any other enactment provided that where a prohibition or restriction which is imposed, varied or revoked by this Order is in conflict with a prohibition or restriction imposed by a previous Order, then the provision of this Order shall prevail.

2.4 The Off-Street Plan forming Schedule 1 to this Order and titled "The Inverclyde Council (Off-Street Parking Places) (Variation No. 7) Order 2016 Off-Street Plan" is hereby incorporated into "The Inverclyde Council (Off-Street Parking Places) Order 2013" and recorded in "The Inverclyde Council (Off-Street Parking Places) Order 2013 Plan Index".

2.5 The Plan Index forms Schedule 2.

2.6 The Schedule forming Schedule 3 to this Order and titled "Parking Places, Number and Name, Charging Hours, Days and Hours of Parking Place Operation, Maximum period for which vehicles may wait, Tariff and Disabled Persons' Parking Places" is hereby incorporated into "The Inverclyde Council (Off-Street Parking Places) Order 2013".

2.7 The Schedule forming Schedule 4 to this Order and titled "Scale of Parking Charges applicable during the Hours of Operation for Parking Places specified in the Schedule 3" is hereby incorporated into "The Inverclyde Council (Off-Street Parking Places) Order 2013".

2.8 The Interpretation Act 1978 (as amended) shall apply for the interpretation of this Order as it applies for the interpretation of an Act of Parliament. *This Order and the four Schedules annexed hereto are sealed with the Common Seal of The Inverclyde Council and subscribed for them and on their behalf by Gerard Joseph Malone, Proper Officer and an authorised signatory at Greenock on the Thirtieth day of September Two Thousand and Sixteen.*

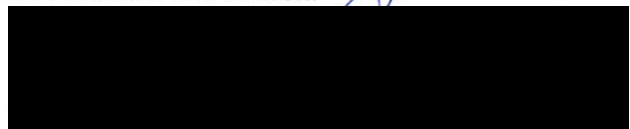

SCHEDULE 1

The Inverclyde Council (Off-Street Parking Places) (Variation No. 7) Order 2016 Off-Street Plan

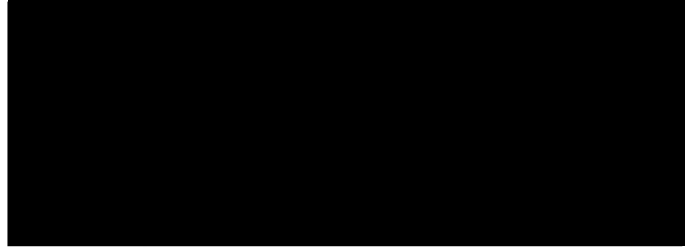

DO NOT SCALE

A3
 0 10 50

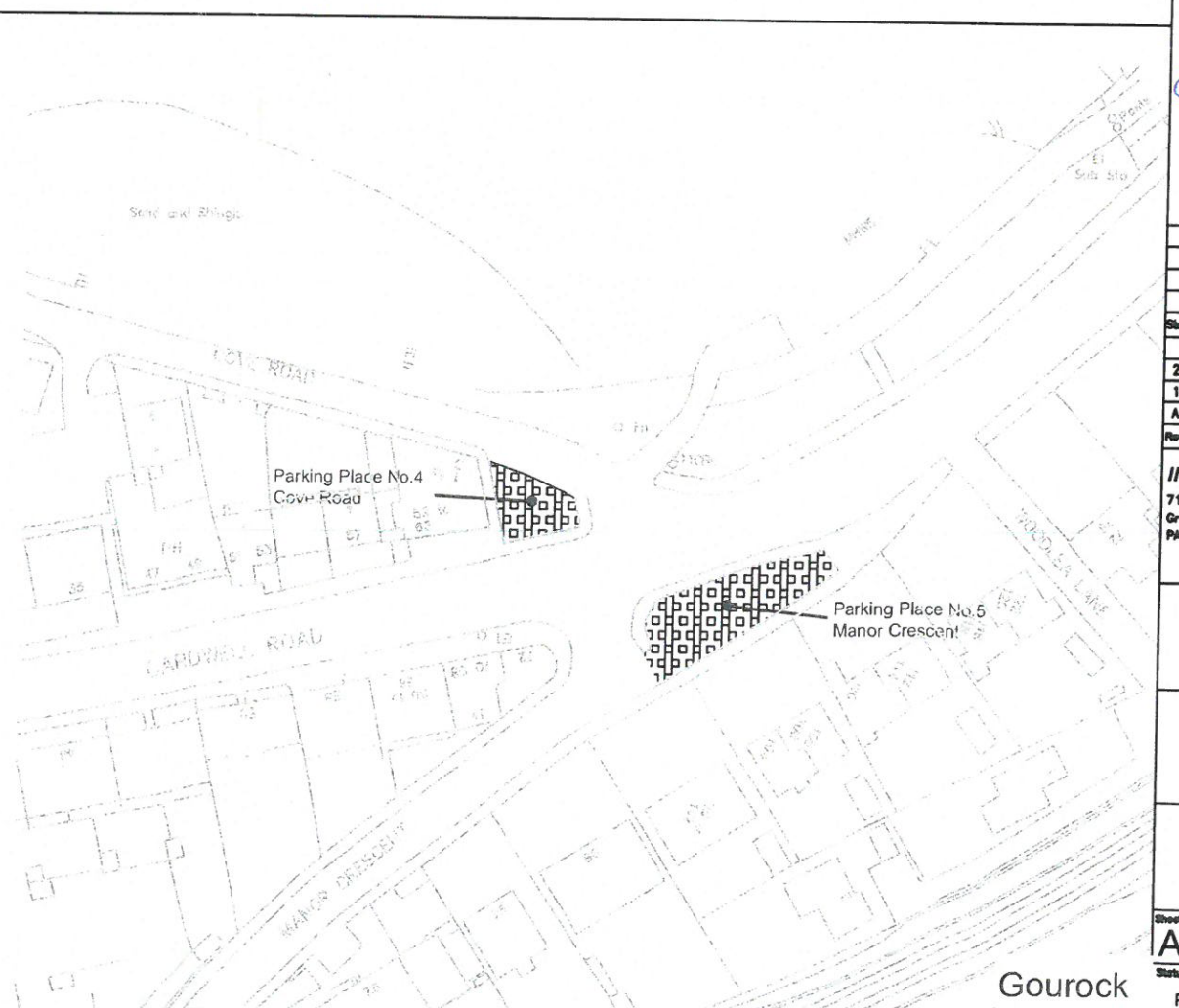
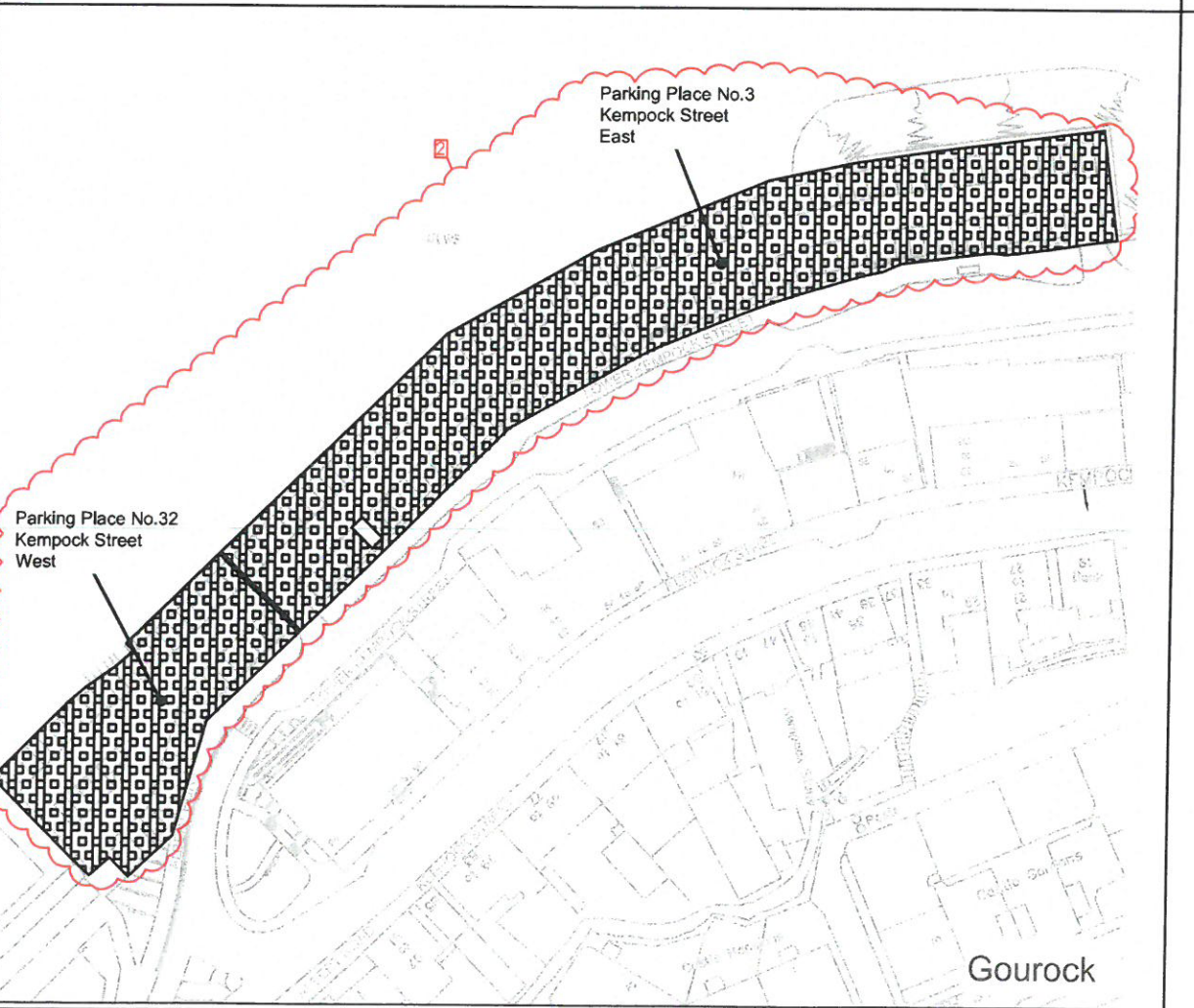
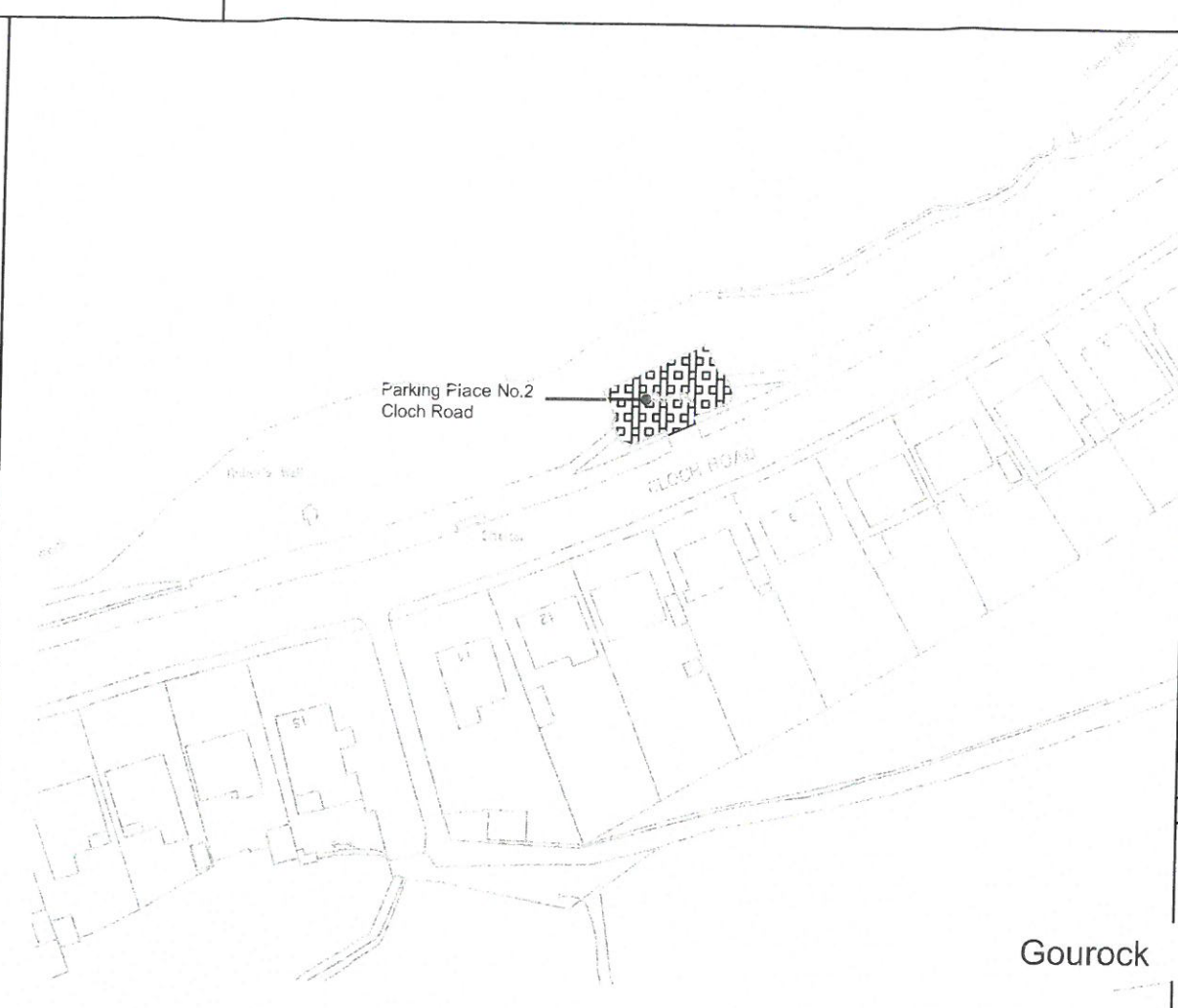
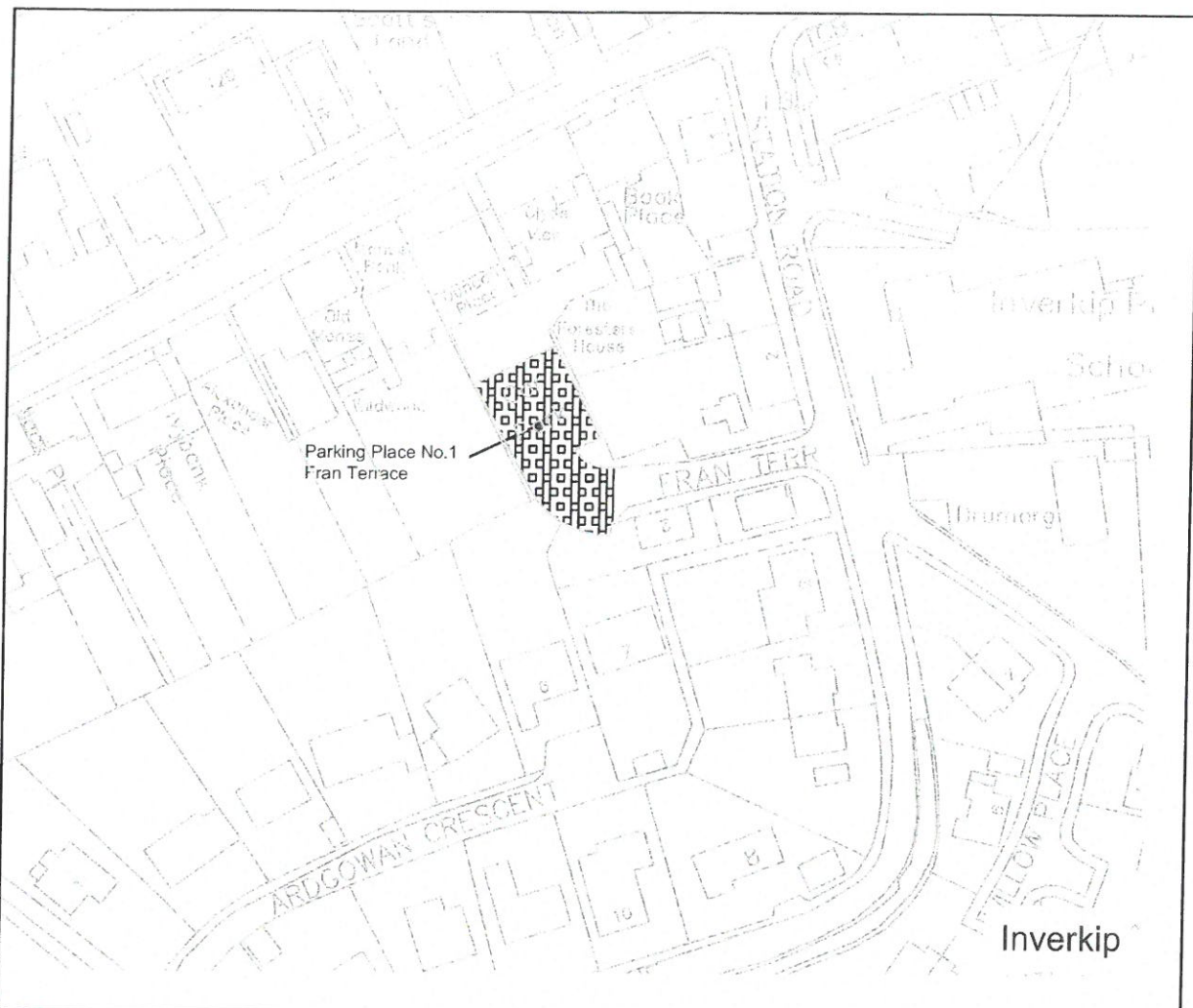

Key

Extent of off-street parking place

© Crown copyright and database rights 2013 Ordnance Survey 100023421

| Stat | Purpose of Issue | Date | Auth |
|------|--------------------------------------|--------------|--------|
| 2 | KEMPOCK STREET CAR PARK AMENDED | EP JUN '16 | EP MH |
| 1 | KEMPOCK ST CAR PARKS AMENDED/RENAMED | EP JUN '15 | EP MH |
| A | COVE RD AND MANOR CRES NOTE REMOVED | MJH JUNE '13 | MJH MR |

| Rev | Description | By | Date | Chk'd | Auth |
|-----|--------------------------------------|-----|----------|-------|------|
| 2 | KEMPOCK STREET CAR PARK AMENDED | EP | JUN '16 | EP | MH |
| 1 | KEMPOCK ST CAR PARKS AMENDED/RENAMED | EP | JUN '15 | EP | MH |
| A | COVE RD AND MANOR CRES NOTE REMOVED | MJH | JUNE '13 | MJH | MR |

INVERCLYDE COUNCIL
 71 East Hamilton Street
 Gourock
 PA15 2UA
 Tel: 01475 717171
 Email: roads@inverclyde.gov.uk
 www.inverclyde.gov.uk



THE INVERCLYDE COUNCIL
 (OFF-STREET PARKING PLACES)
 (VARIATION No. 7) ORDER 2016

EFFECTIVE DATE:

| Sheet Size | Original Scale | Designed/Drawn | Checked | Authorised |
|------------|-----------------|----------------|---------|------------|
| A3 | 1:1250 | MJH | MJH | MR |
| Status | Drawing Number | Date | Date | Date |
| P | TR/TRO/C134-001 | FEB '13 | FEB '13 | FEB '13 |

SCHEDULE 2

SCHEDULE 5

THE INVERCLYDE COUNCIL (OFF-STREET PARKING PLACES) ORDER 2013 PLAN INDEX

| Plan Ref. | Effective date of original plan | Effective date of Plan Revision | | | | | | | |
|-----------------|---------------------------------|---------------------------------|------------|---|---|---|---|---|---|
| | | 1 | 2 | 3 | 4 | 5 | 6 | 7 | 8 |
| TR/TRO/C134/001 | 06/10/2014 | 18/01/2016 | 14/11/2016 | | | | | | |
| TR/TRO/C134/002 | 06/10/2014 | 25/04/2016 | | | | | | | |
| TR/TRO/C134/003 | 06/10/2014 | | | | | | | | |
| TR/TRO/C134/004 | 06/10/2014 | 25/04/2016 | | | | | | | |
| TR/TRO/C134/005 | 06/10/2014 | | | | | | | | |
| TR/TRO/C134/006 | 06/10/2014 | | | | | | | | |
| TR/TRO/C134/007 | 21/11/2014 | | | | | | | | |
| TR/TRO/C134/008 | 25/01/2016 | | | | | | | | |

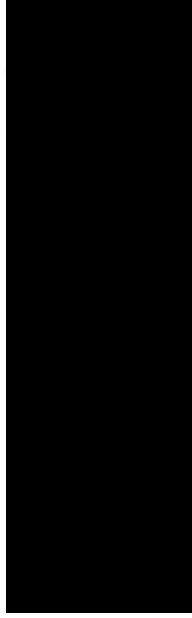

SCHEDULE 3

SCHEDULE 3

PARKING PLACES, NUMBER AND NAME, CHARGING HOURS, DAYS AND HOURS OF PARKING PLACE OPERATION, MAXIMUM PERIOD FOR WHICH VEHICLES MAY WAIT, TARIFF AND DISABLED PERSONS' PARKING PLACES

Parking Places Operational at all times

| PARKING PLACE REFERENCE NUMBER | NAME OF PARKING PLACE | CHARGING HOURS OF PARKING PLACE | OPENING HOURS OF PARKING PLACE | TARIFF | DISABLED PERSONS' PARKING PLACES (No.) | ELECTRIC VEHICLE PARKING SPACES (No.) | PARKING PLACE IDENTIFICATION CODE |
|---------------------------------------|------------------------------|--|---------------------------------------|-----------------|---|--|--|
| Column 1 | Column 2 | Column 3 | Column 4 | Column 5 | Column 6 | Column 7 | Column 8 |
| 25 | Barr's Brae | 08:00-18:00 Mon-Sat | 24 hours | A | 1 | | |
| 9 | Bruce Street | 08:00-18:00 Mon-Sat | 24 hours | A | 3 | | |
| 12 | Buccleugh Street | 08:00-18:00 Mon-Sat | 24 hours | H | 1 | | GR2 |
| 11 | Bullring | 08:00-18:00 Mon-Fri | 24 hours | E | 4 | | GR1 |
| 13 | Cathcart Street West | 08:00-18:00 Mon- Fri | 24 hours | F | 4 | | GR1 |
| 14 | Cathcart Street East | 08:00-18:00 Mon- Fri | 24 hours | E | 1 | 2 | GR1 |
| 2 | Cloch Road | 08:00-18:00 Mon-Sat | 24 hours | A | 0 | | |
| 4 | Cove Road | 08:00-18:00 Mon-Sat | 24 hours | A | 0 | | |
| 22 | East Road | 08:00-18:00 Mon-Sat | 24 hours | A | 0 | | |

| PARKING PLACE REFERENCE NUMBER Column 1 | NAME OF PARKING PLACE Column 2 | CHARGING HOURS OF PARKING PLACE Column 3 | OPENING HOURS OF PARKING PLACE Column 4 | TARIFF Column 5 | DISABLED PERSONS' PARKING PLACES (No.) Column 6 | ELECTRIC VEHICLE PARKING SPACES (No.) Column 7 | PARKING PLACE IDENTIFICATION CODE Column 8 |
|--|-----------------------------------|---|--|--------------------|--|---|---|
| 19 | Fore Street | 08:00-18:00 Mon-Sat | 24 hours | A | 8 | 2 | |
| 1 | Fran Terrace | 08:00-18:00 Mon-Sat | 24 hours | A | 0 | | |
| 7 | Hastie Street | 08:00-18:00 Mon- Fri | 24 hours | E | 2 | | GR1 |
| 21 | Highholm Avenue | 08:00-18:00 Mon-Sat | 24 hours | A | 8 | | |
| 3 | Kempock Street East | 08:00-18:00 Mon-Sat | 24 hours | A | 2 | | |
| 24 | Lochwinnoch Road | 08:00-18:00 Mon-Sat | 24 hours | A | 6 | 2 | |
| 5 | Manor Crescent | 08:00-18:00 Mon-Sat | 24 hours | A | 0 | | |
| 20 | Princes Street | 08:00-18:00 Mon-Sat | 24 hours | B | 6 | | |
| 8 | Roslin Street | 08:00-18:00 Mon- Fri | 24 hours | E | 0 | | GR1 |
| 10 | Roxburgh Street | 08:00-18:00 Mon-Sat | 24 hours | A | 2 | | |
| 18 | Shore Street | 08:00-18:00 Mon-Sat | 24 hours | A | 11 | | |
| 16 | Station Avenue East | 08:00-18:00 Mon- Fri | 24 hours | E | 2 | | GR1 |
| 15 | Station Avenue West | 08:00-18:00 Mon- Fri | 24 hours | E | 2 | | GR1 |

| PARKING PLACE REFERENCE NUMBER Column 1 | NAME OF PARKING PLACE Column 2 | CHARGING HOURS OF PARKING PLACE Column 3 | OPENING HOURS OF PARKING PLACE Column 4 | TARIFF Column 5 | DISABLED PERSONS' PARKING PLACES (No.) Column 6 | ELECTRIC VEHICLE PARKING SPACES (No.) Column 7 | PARKING PLACE IDENTIFICATION CODE Column 8 |
|--|-----------------------------------|---|--|--------------------|--|---|---|
| 23 | Station Road | 08:00-18:00 Mon-Sat | 24 hours | A | 1 | | |
| 6 | West Stewart Street | 08:00-18:00 Mon- Fri | 24 hours | E | 2 | | GR1 |
| 17 | William Street | 08:00-18:00 Mon-Sat | 24 hours | A | 1 | | |
| 26 | Waterfront | 08:00-18:00 Mon- Fri | 24 hours | A | 2 | | |
| 27 | Cinema | 08:00-18:00 Mon- Fri | 24 hours | C | 2 | | |
| 28 | Dalrymple Street | 08:00-18:00 Mon- Fri | 24 hours | E | 4 | | GR1 |
| 29 | Cathcart Buildings | 08:00-18:00 Mon- Fri | 24 hours | G | 0 | | GR1 |
| 30 | Station Road North | 08:00-18:00 Mon- Sat | 24 hours | D | 0 | | |
| 31 | Station Road South | 08:00-18:00 Mon- Sat | 24 hours | D | 0 | | |
| 32 | Kempock Street West | 08:00-18:00 Mon- Sat | 24 hours | C | 2 | 2 | |



SCHEDULE 4

SCHEDULE 4

SCALE OF PARKING CHARGES APPLICABLE DURING THE HOURS OF OPERATION FOR PARKING PLACES SPECIFIED IN SCHEDULE 3

| TARIFF Column 1 | CHARGES Column 2 | MAXIMUM DURATION OF STAY Column 3 | NO RETURN WITHIN Column 4 | DISPLAY TICKET/PARKING DISC/NONE Column 5 | COMMENTS Column 6 |
|--------------------|---|---|------------------------------------|---|---|
| A | Free | 24 hours | n/a | None | n/a |
| B | Free | 2 hours (3 hours for Disabled Person's Badge holders) | 1 hour | None or Disabled Person's Badge | n/a |
| C | Free | 3 hours (3 hours for Disabled Person's Badge holders) | 1 hour | Parking Disc or Disabled Person's Badge | n/a |
| D | £1.00 per calendar day (Free for Disabled Person's Badge holders) | One calendar day | n/a | Ticket or Disabled Person's Badge | Multiple stays in one calendar day are permitted if space is available on return |
| E | £1.00 per calendar day (Free for Disabled Person's Badge holders) | One calendar day | n/a | Ticket or Residents' Parking Permit or Disabled Person's Badge | Multiple stays in one calendar day are permitted if space is available on return |
| F | Free | 3 hours (3 hours for Disabled Person's Badge holders) | 1 hour | Parking Disc or Residents' Parking Permit or Disabled Person's Badge | n/a |
| G | Free | Unlimited | n/a | Residents' Parking Permit or Disabled Person's Badge | n/a |
| H | Free | Unlimited | n/a | Residents' Parking Permit | n/a |

